

The IRWIN 46 ft Ketch Specifications

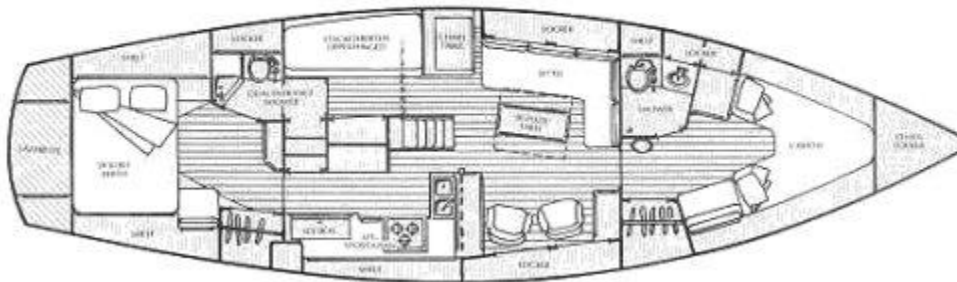
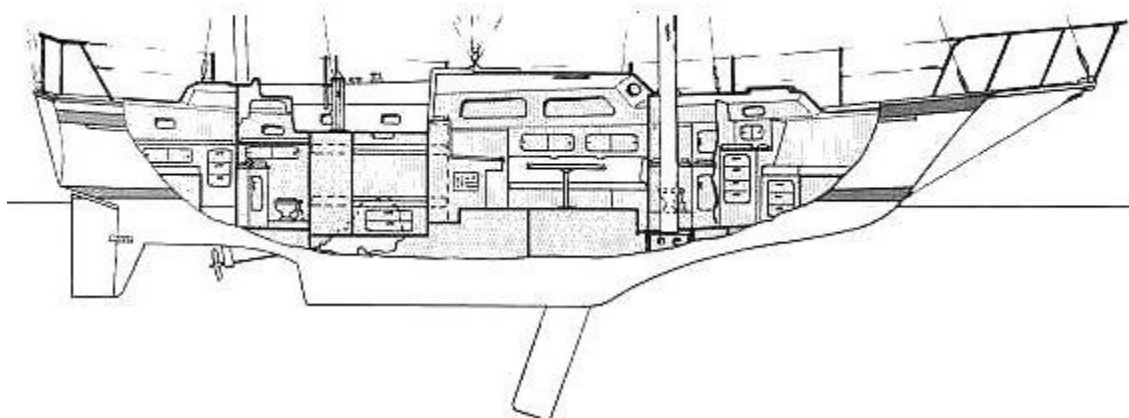

Hull Type:	Keel/Cbrd.	Rig Type:	Staysail Ketch
LOA:	45.50' / 13.87m	LWL:	37.58' / 11.45m
Beam:	13.50' / 4.11m	Listed SA:	858 ft ² / 79.71 m ²

Draft (max.)	10.92' / 3.33m	Draft (min.)	4.67' / 1.42m		
Displacement:	33000 lbs./ 14969 kgs.	Ballast:	12000 lbs. / 5443 kgs.		
Sail Area/Disp.1:	13.40	Bal./Disp.:	36.36%	Disp./Len.:	277.58
Designer:	Ted Irwin				
Builder:	Irwin Yachts (USA)				
Construction:	FG	Bal. type:			
First Built:	1980	Last Built:		# Built:	
AUXILIARY POWER (orig. equip.)					
Make:	Perkins	Model:	4-154		
Type:	Diesel	HP:			
TANKS					
Water:	190 gals. / 719 ltrs.	Fuel:	190 gals. / 719 ltrs.		
RIG AND SAIL PARTICULARS KEY					
I(IG):	53.00' / 16.15m	J:	19.50' / 5.94m		
P:	47.00' / 14.33m	E:	14.50' / 4.42m		
PY:	28.75' / 8.76m	EY:	9.75' / 2.97m		
ISP:		SPL/TPS:			
SA(Fore.):	516.75 ft ² / 48.01 m ²	SA(Main):	340.75 ft ² / 31.66 m ²		
Sail Area (100% fore+main triangles):			997.66 ft ² / 92.68 m ²		
Sail Area/Disp.2:	15.58	Est. Forestay Length.:	56.47' / 17.21m		
Mast Height from DWL:	58.00' / 17.68m				
BUILDERS (past & present)					
More about & boats built by:			Irwin Yachts		
DESIGNER					
More about & boats designed by:			Ted Irwin		
© 2003-2016 sailboatdata.com All rights reserved.					